

18" C515 FLG X FLG

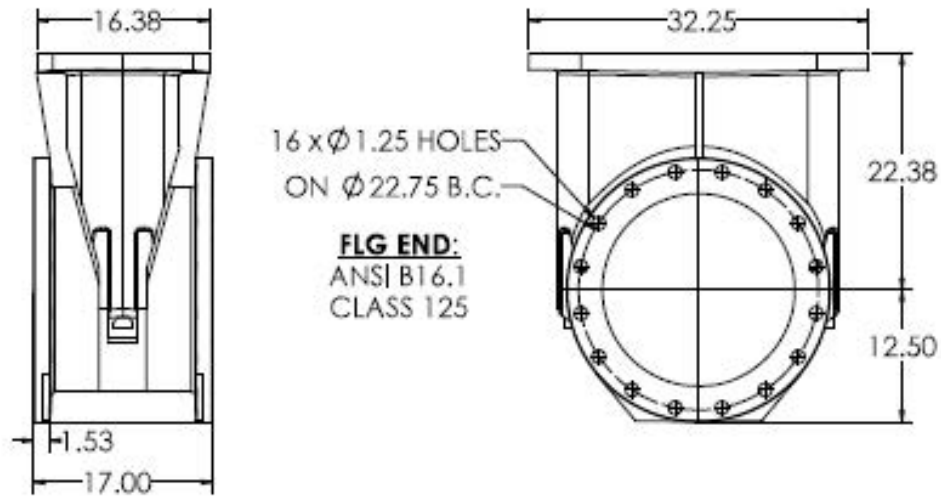

OTHER END CONNECTIONS ARE AVAILABLE UPON REQUEST.

| | | | | | |
|--|-------------------------------|--|---------------------------------|--|---------------------------------|
| 18" C515 FLG X FLG <small>EXCEPT WHERE SHOWN OTHERWISE, DIMENSIONS ARE IN INCHES AND DECIMALS THEREOF.</small> | | <small>REVISIONS TO THIS DRAWING SHALL BE MADE BY THE ORIGINAL DESIGNER OR ANOTHER QUALIFIED PERSONNEL AS APPROVED BY THE ORIGINAL DESIGNER.</small> | | <small>DATE</small> 12/01/20 | <small>SCALE</small> 1:1 |
| <small>DATE</small> 12/01/20 | <small>DESIGNER</small> DW | <small>CHECKED</small> DW | <small>APPROVED</small> DW | <small>PROJECT</small> 18" C515 OS&Y RESILIENT WEDGE GATE VALVE | <small>REV</small> 1.8 |
| <small>WORKSHEET</small> DW | | | <small>DATE</small> 12/01/20 | | |
| <small>PROJECT</small> 18" C515 OS&Y RESILIENT WEDGE GATE VALVE | | | | <small>REV</small> 1.8 | <small>DATE</small> 12/01/20 |
| <small>WORKSHEET</small> DW | | | | | <small>REV</small> 1.8 |
| <small>DATE</small> 12/01/20 | | | | | <small>REV</small> 1.8 |
| <small>PROJECT</small> 18" C515 OS&Y RESILIENT WEDGE GATE VALVE | | | | | <small>REV</small> 1.8 |
| <small>WORKSHEET</small> DW | | | | | <small>REV</small> 1.8 |
| <small>DATE</small> 12/01/20 | | | | | <small>REV</small> 1.8 |



18" C515 OS&Y RESILIENT WEDGE GATE VALVE

REV 1.8

12/01/20

1.8

18" C515 OS&Y RESILIENT WEDGE GATE VALVE

REV 1.8

12/01/20

1.8

18" C515 OS&Y RESILIENT WEDGE GATE VALVE

REV 1.8

12/01/20

1.8

BEVEL GEAR WITH OPERATING NUT

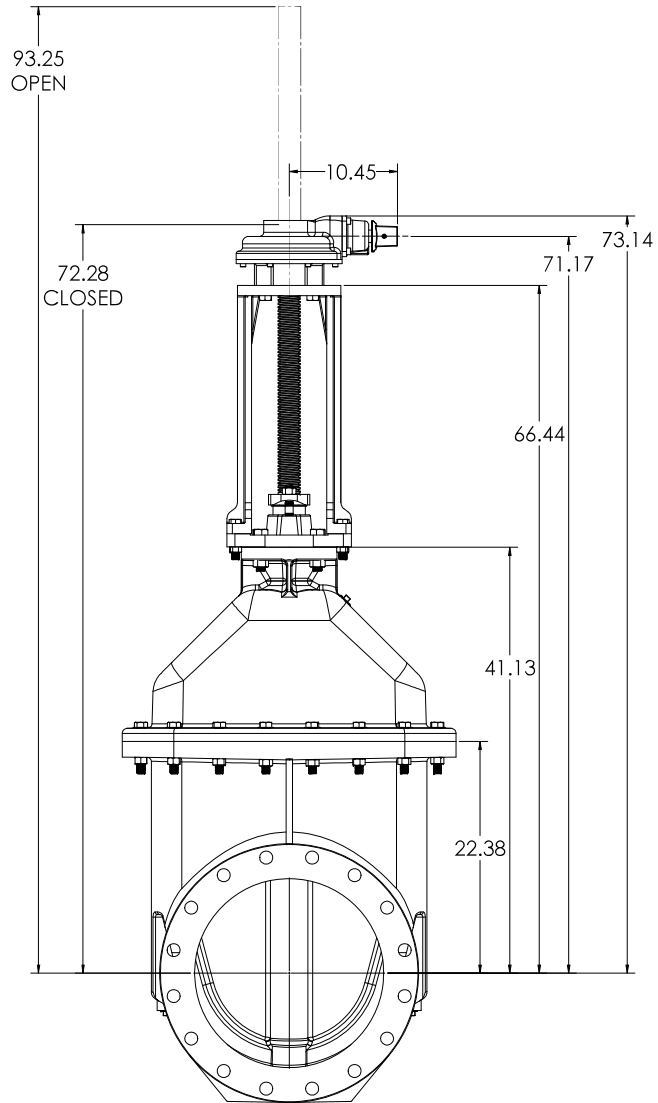

SPUR GEAR WITH OPERATING NUT

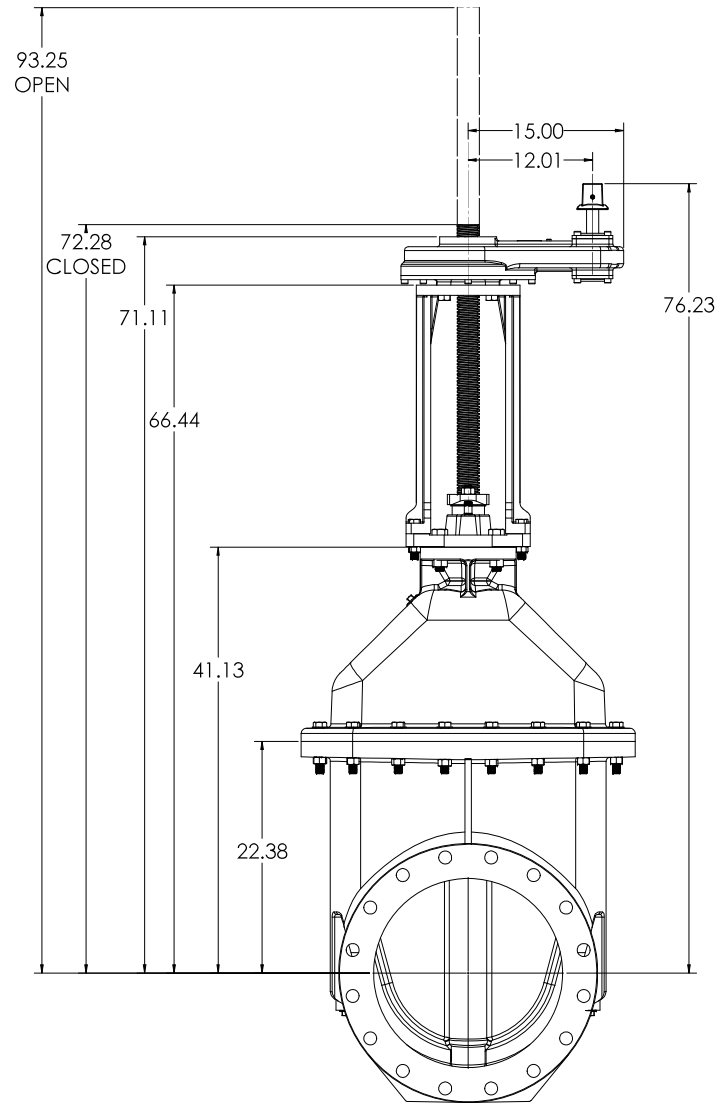

| | | | | | |
|---|----------------------|--|--------------------------------|----------------------------|--------------------|
| REVISED DWG NO. 1341420 DATE 10/1/16 | | 18" CS15 CS&Y RESILIENT WEDGE GATE VALVE | | 2 7 | |
| DWG NO. 1341420 DATE 10/1/16 | SCALE 1:5 SHEET 7 | PROJECT NO. 1341420 PROJECT NAME 18" CS15 CS&Y RESILIENT WEDGE GATE VALVE | DRAWN BY DWI CHECKED BY TSC | DESIGNED BY APPROVED BY | SOLEWORKS 2016 SP2 |

BEVEL GEAR WITH HANDWHEEL

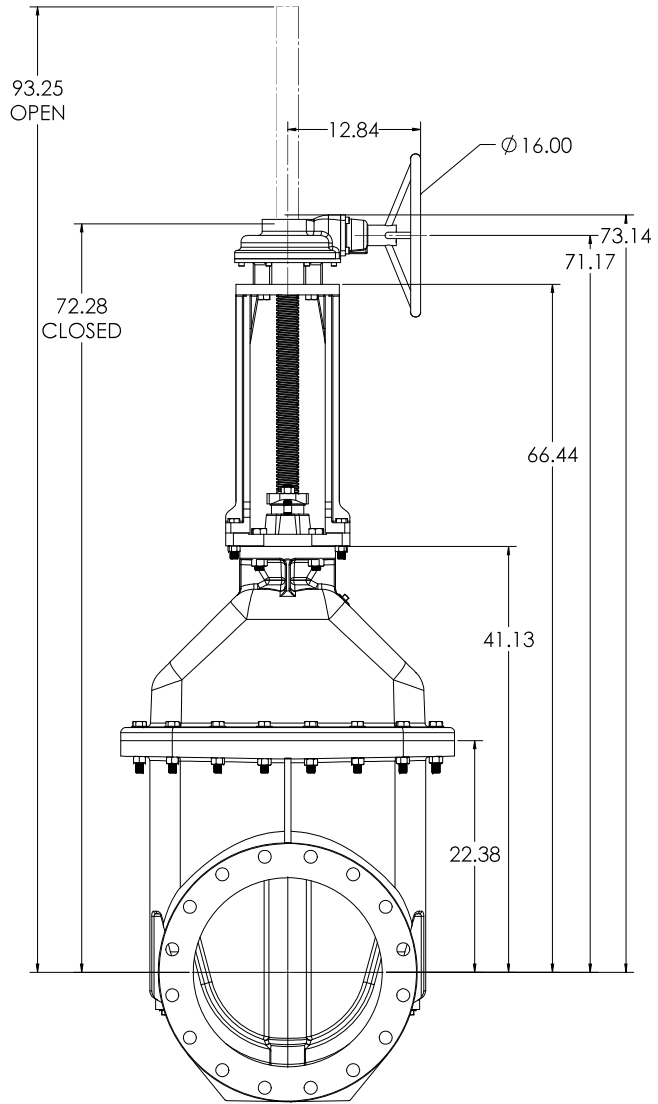

SPUR GEAR WITH HANDWHEEL

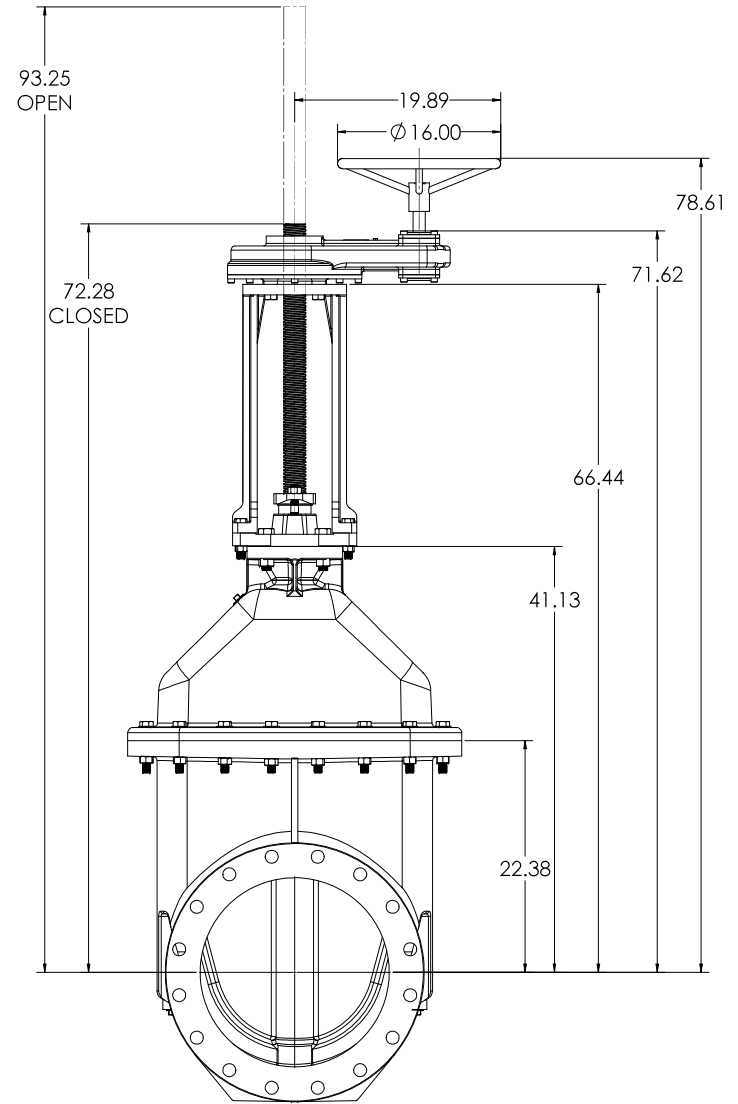

| | | | | | |
|--|-------------------------|--|---------------------------|---------------------|--------------------------------------|
| REVISED DWG NO: 1041420 DATE: 10/1/16 DESIGNED BY: [REDACTED] CHECKED BY: [REDACTED] APPROVED BY: [REDACTED] | | DESCRIPTION 18" CS15 CS&Y RESILIENT WEDGE LBS. GATE VALVE | | SCALE T:6 | PROJECT SalsWorks 2016 SP2 |
| DATE 10/1/16 | BY [REDACTED] | CHKD [REDACTED] | APPD [REDACTED] | NO. 3 | REV. 7 |

BARE STEM

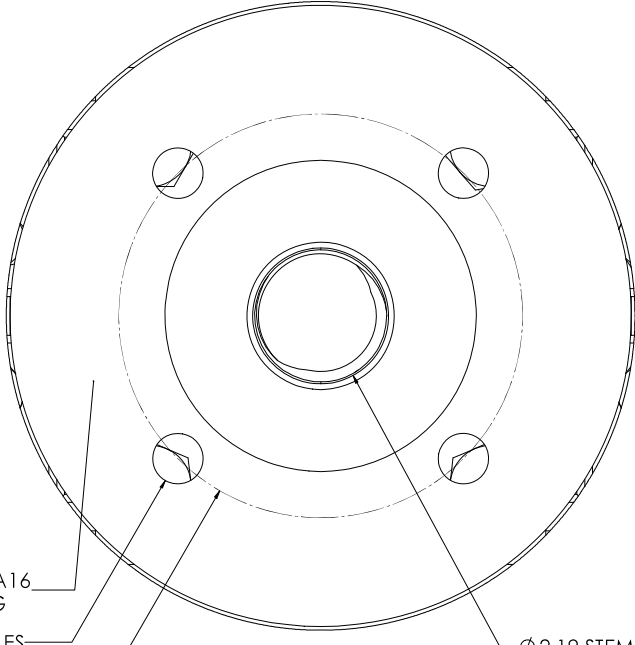
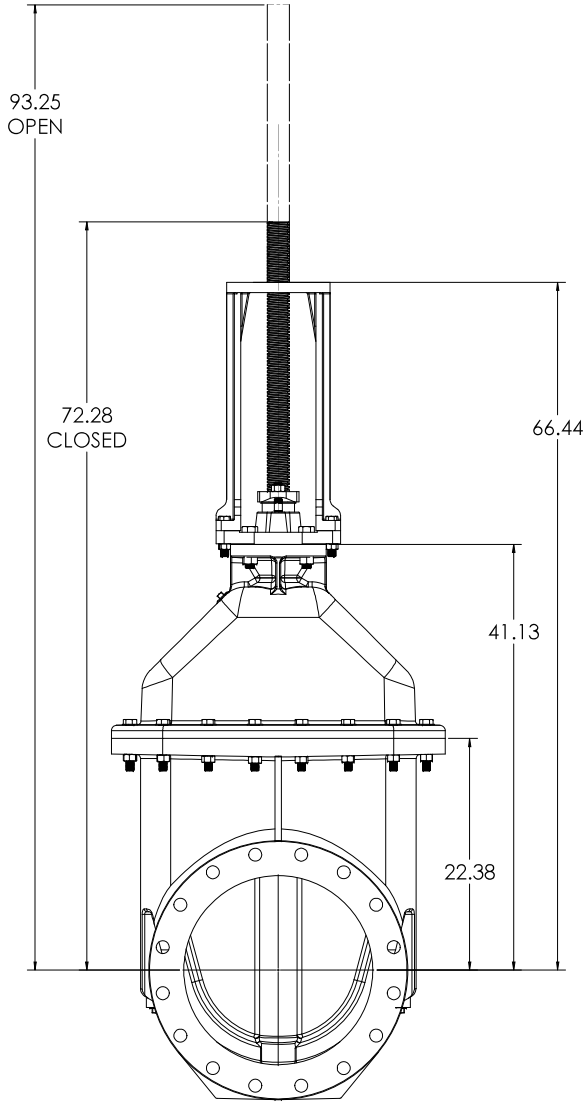

STANDARD FA 16
MOUNTING

4 X Ø .81 HOLES
ON Ø 6.50 B.C.

Ø 2.19 STEM

**BARE STEM
MOUNTING FLANGE**

| | | | | | |
|--|--|--|-------------------------------|-------------------------------|-----------------|
| REVISED DWG NO. 1041420 DATE 10/15/10 | | PROJECT NO. 1041420 PROJECT NAME 18" CS15 CS&Y RESILIENT WEDGE GATE VALVE | | SHEET NO. 4 TOTAL SHEETS 7 | |
| DESIGNED BY DWG NO. 1041420 DATE 10/15/10 | CHECKED BY DWG NO. 1041420 DATE 10/15/10 | PROJECT NO. 1041420 PROJECT NAME 18" CS15 CS&Y RESILIENT WEDGE GATE VALVE | SHEET NO. 4 TOTAL SHEETS 7 | SCALE T:6 | DWG NO. 1041420 |

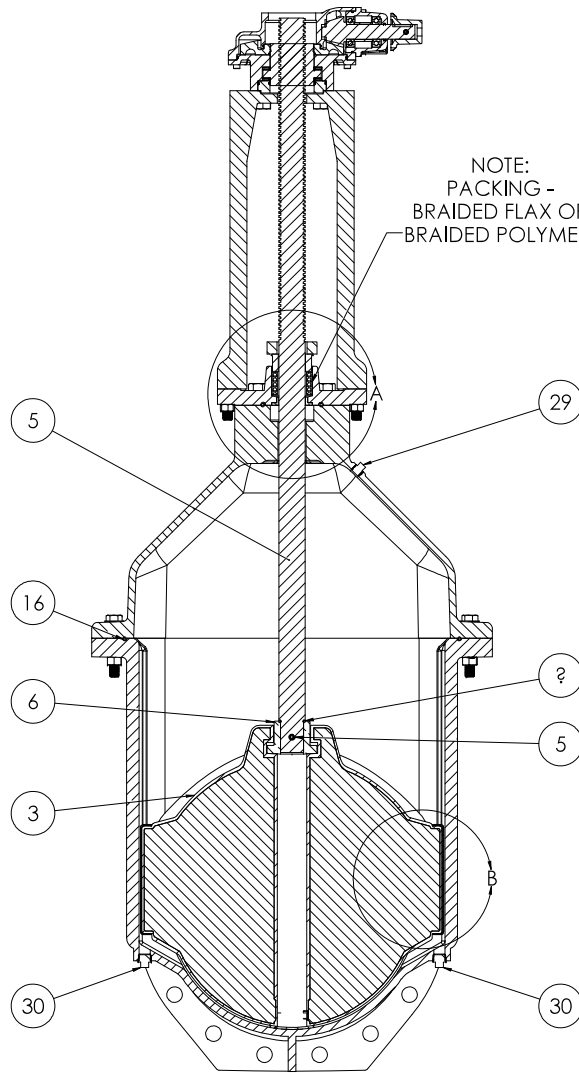
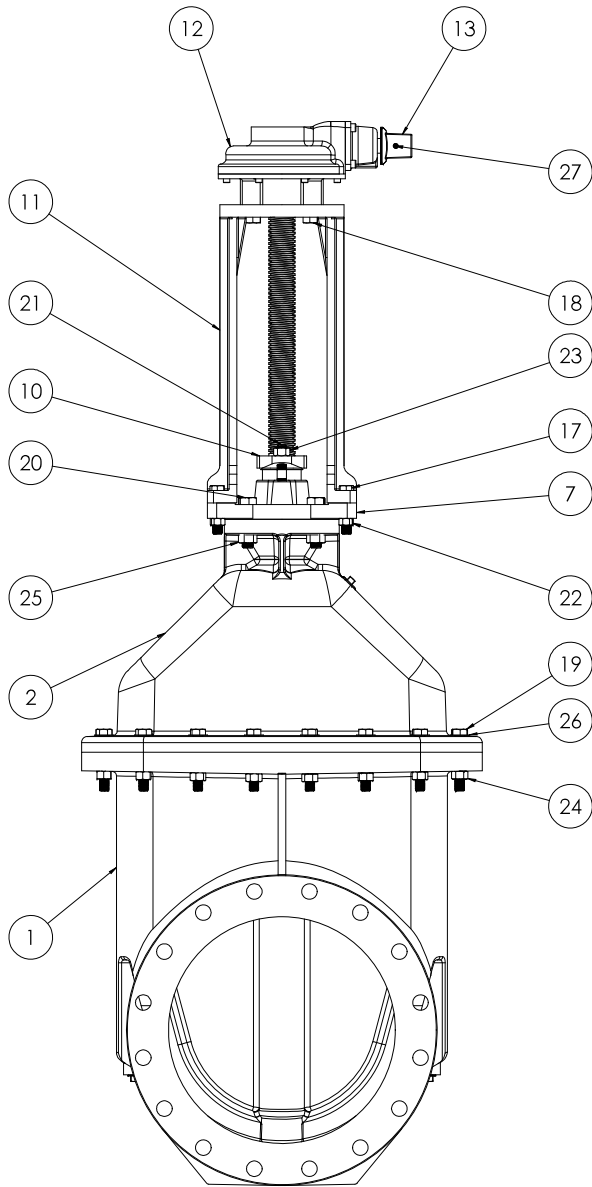

NOTE:
PACKING -
BRAIDED FLAX OR
BRAIDED POLYMER

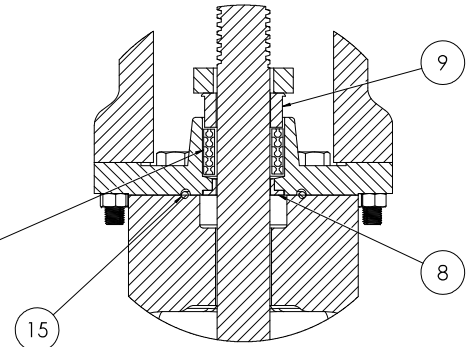

DETAIL A

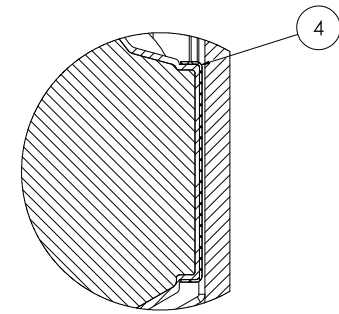

DETAIL B

| | | | | |
|--|--|---|--|--|
| DWG NO: 1041420 DATE: 01/15/10 DESIGNED BY: DWI CHECKED BY: TSC APPROVED BY: DWI | | PROJECT NO: 1041420 PROJECT NAME: 18" CS15 CS&Y RESILIENT WEDGE GATE VALVE SCALE: 1:5 SHEET NO: 7 TOTAL SHEETS: 7 | | |
|--|--|---|--|--|

| <u>ITEM NO.</u> | <u>COMPONENT</u> | <u>QTY.</u> | <u>SIZE</u> | <u>STANDARD MATERIAL</u> | <u>MATERIAL OPTIONS</u> |
|-----------------|--------------------|-------------|------------------|--------------------------|--|
| 1 | BODY | 1 | - | DUCTILE IRON | - |
| 2 | COVER | 1 | - | DUCTILE IRON | - |
| 3 | WEDGE | 1 | - | EPDM/DUCTILE IRON | - |
| 4 | Wedge Cap | 4 | - | DELTRIN | - |
| 5 | STEM | 1 | 2 1/8" | C65500 | 304 SS, 316 SS |
| 6 | STEM NUT | 1 | - | C86200 | C99500 304 SS, 316 SS |
| 7 | STUFFING BOX | 1 | - | DUCTILE IRON | - |
| 8 | BUSHING | 1 | - | C87850 | - |
| 9 | GLAND | 1 | - | C87850 | - |
| 10 | FOLLOWER PLATE | 1 | - | DUCTILE IRON | - |
| 11 | YOKE | 1 | - | DUCTILE IRON | - |
| 12 | BEVEL GEAR | 1 | - | - | - |
| 13 | OPERATING NUT | 1 | - | CAST IRON | 304 SS, C86700 ** ϕ 16" HANDWHEEL ** |
| 14 | O-RING | 1 | #327 | EPDM | BUNA-N |
| 15 | O-RING | 1 | #425 | EPDM | BUNA-N |
| 16 | O-RING | 1 | #469 | EPDM | BUNA-N |
| 17 | HEX HEAD CAPSCREW | 8 | 5/8"-11 X 3 1/2" | 18-8 SS | 316 SS |
| 18 | HEX HEAD CAPSCREW | 4 | 3/4"-10 X 3 1/2" | 18-8 SS | 316 SS |
| 19 | HEX HEAD CAPSCREW | 16 | 3/4"-10 X 4 1/2" | 18-8 SS | 316 SS |
| 20 | HEX HEAD CAP SCREW | 4 | 7/8"-9 X 3 1/2" | 18-8 SS | 316 SS |
| 21 | STUD | 2 | 3/4" X 3 3/4" | YELLOW ZINC | 316 SS |
| 22 | HEX NUT | 8 | 5/8"-11 | 18-8 SS | 316 SS |
| 23 | HEX NUT | 2 | 3/4"-10 | BRASS | - |
| 24 | HEX NUT | 16 | 3/4"-10 | 18-8 SS | 316 SS |
| 25 | HEX NUT | 4 | 7/8"-9 | 18-8 SS | 316 SS |
| 26 | FLAT WASHER | 16 | 3/4"-10 | 18-8 SS | 316 SS |
| 27 | COILED SPRING PIN | 1 | 10mm X 45mm | 302 SS OR 304 SS | - |
| 28 | COILED SPRING PIN | 1 | 1/2" X 3 1/4" | 303 SS | - |
| 29 | PIPE PLUG | 1 | 1/2" - NPT | 304 SS | 316 SS |
| 30 | PIPE PLUG | 2 | 3/4" - NPT | 18-8 SS | 316 SS |

- VALVES CONFORM WITH FOLLOWING STANDARDS
 - AWWA C515
 - NSF 61
- LOW ZINC BRASS STEM AND STEM NUT AVAILABLE
- 100% DOMESTIC FASTENER AND O-RING OPTIONS AVAILABLE
- OPEN LEFT (COUNTERCLOCKWISE) AND OPEN RIGHT (CLOCKWISE) OPTIONS AVAILABLE
- TURNS TO OPEN FROM FULLY CLOSED: 192
 - +/- 5% WITH STANDARD 3:1 BEVEL OR SPUR GEAR
- AWWA MAXIMUM ALLOWABLE CLOSING TORQUE 250 FT-LBS WITH STANDARD GEARING
- OPTIONAL HANDWHEEL CAN BE SUBSTITUTED FOR STANDARD 2" SQUARE OP NUTS
 - **NOTE: STANDARD HANDWHEEL SIZE CALLED OUT IN PARTS LIST**

| | | | |
|--|--|--|---|
| <small> COMPANY: 18" CS&Y RESILIENT WEDGE GATE VALVE DATE: 1/20/20 DWG: 1841420 </small> | | <small> SCALE: 1:5 SHEET: 6 OF 7 </small> |  |
|--|--|--|---|