

## 03" C509 FLG X FLG

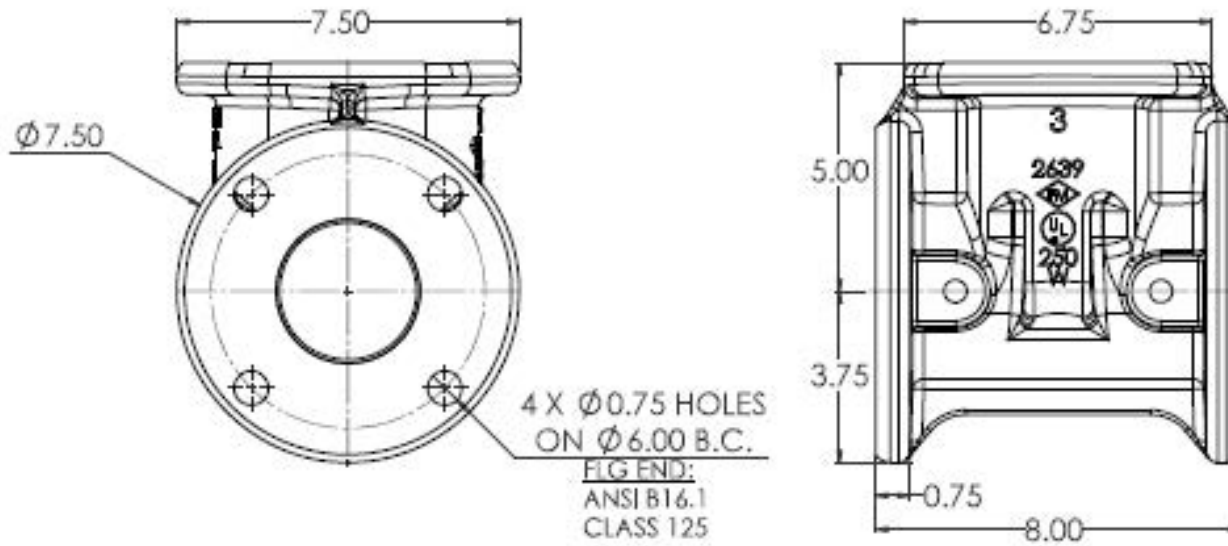

OTHER END CONNECTIONS ARE AVAILABLE UPON REQUEST.

<b>WILSON JOINTS</b> 1100 WILSON DRIVE WILSON, NJ 07094 TEL: 908-675-1100 FAX: 908-675-1101 WWW.WILSONJOINTS.COM		<b>WILSON JOINTS</b> 1100 WILSON DRIVE WILSON, NJ 07094 TEL: 908-675-1100 FAX: 908-675-1101 WWW.WILSONJOINTS.COM		<b>WILSON JOINTS</b> 1100 WILSON DRIVE WILSON, NJ 07094 TEL: 908-675-1100 FAX: 908-675-1101 WWW.WILSONJOINTS.COM	
ORDER NUMBER: 1100 DATE: 12/1/2020 QUANTITY: 1 PRICE: 1.00		ORDER NUMBER: 1100 DATE: 12/1/2020 QUANTITY: 1 PRICE: 1.00		ORDER NUMBER: 1100 DATE: 12/1/2020 QUANTITY: 1 PRICE: 1.00	
PART NUMBER: 1100 DESCRIPTION: 03" C509 OS&Y RESILIENT LBS. WEDGE GATE VALVE		PART NUMBER: 1100 DESCRIPTION: 03" C509 OS&Y RESILIENT LBS. WEDGE GATE VALVE		PART NUMBER: 1100 DESCRIPTION: 03" C509 OS&Y RESILIENT LBS. WEDGE GATE VALVE	
DWG NO: 1100 DATE: 12/1/2020		DWG NO: 1100 DATE: 12/1/2020		DWG NO: 1100 DATE: 12/1/2020	
SCALE: 1:2		SCALE: 1:2		SCALE: 1:2	
SHEET NO: 6		SHEET NO: 6		SHEET NO: 6	

# OS&Y WITH HANDWHEEL

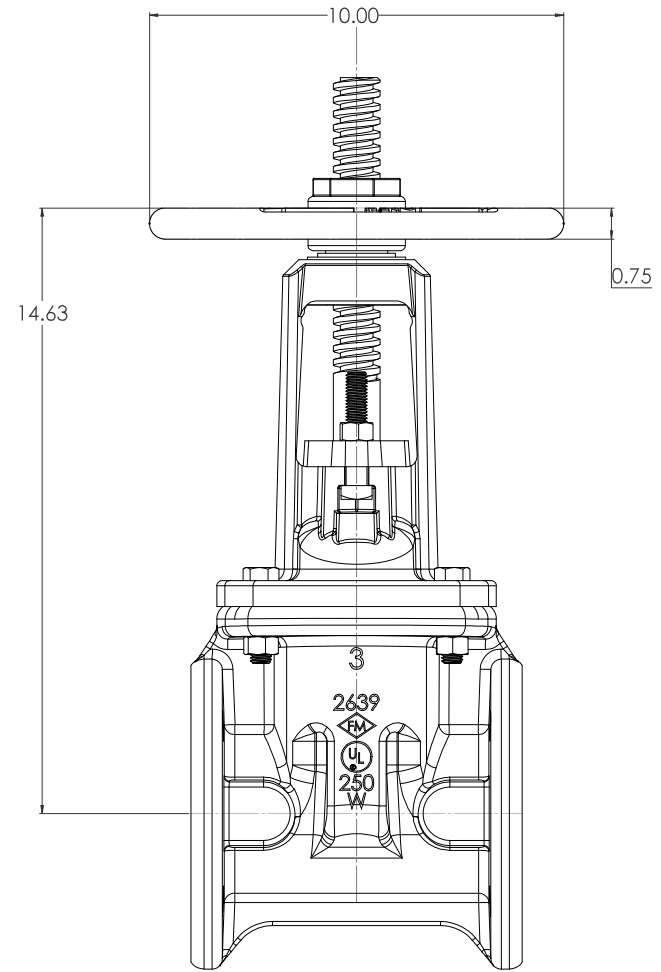
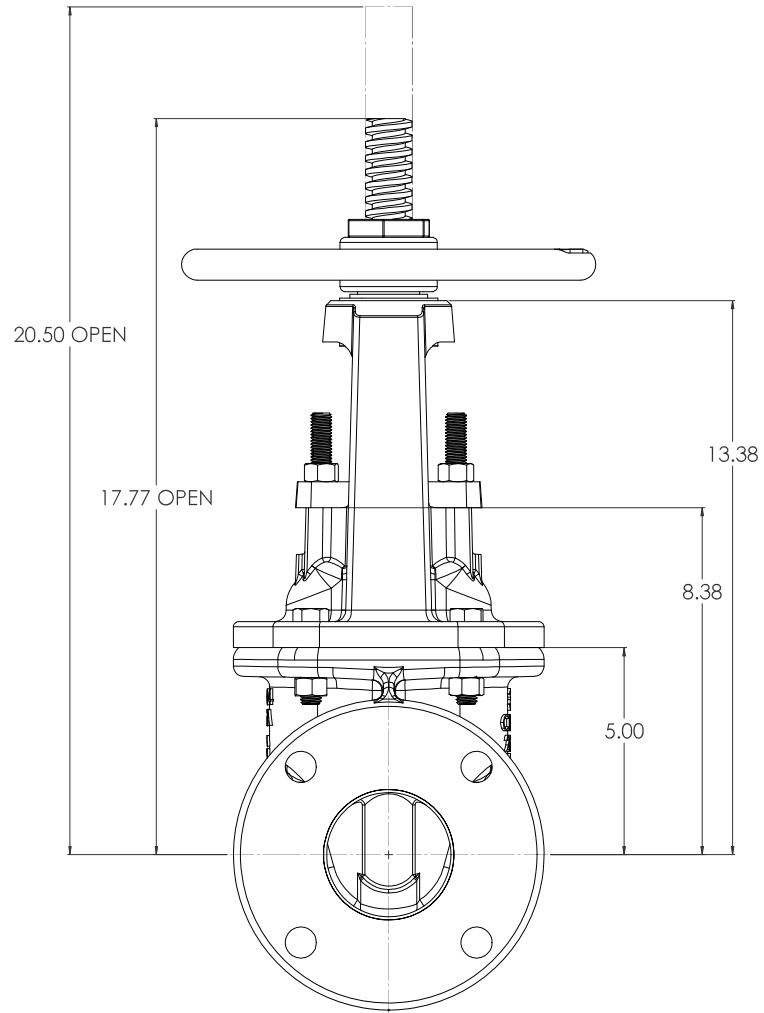

COMPANY: <b>SOLO WORKS</b> ADDRESS: 1221 W. 12TH AVE., SUITE 100 DENVER, CO 80202		PHONE: (303) 733-1100 FAX: (303) 733-1101 WWW: www.soloworks.com		ISO 9001:2015 CERTIFIED ISO 14001:2015 CERTIFIED	
DATE: 12/1/2020 TIME: 10:00 AM DRAWN BY: JACOB CHECKED BY: JACOB	PROJECT: 1221 W. 12TH AVE., SUITE 100 PART: 1221 W. 12TH AVE., SUITE 100 QUANTITY: 100 WEIGHT: 100	PART: 1221 W. 12TH AVE., SUITE 100 QUANTITY: 100 WEIGHT: 100	PART: 1221 W. 12TH AVE., SUITE 100 QUANTITY: 100 WEIGHT: 100	PART: 1221 W. 12TH AVE., SUITE 100 QUANTITY: 100 WEIGHT: 100	PART: 1221 W. 12TH AVE., SUITE 100 QUANTITY: 100 WEIGHT: 100
TITLE: <b>03" C509 OS&amp;Y RESILIENT WEDGE GATE VALVE</b>			SCALE: <b>1:5</b>	DATE: <b>12/1/2020</b>	DRAWN BY: <b>JACOB</b>
MATERIAL: <b>LBS.</b>			WEIGHT: <b>100</b>	PART: <b>1221 W. 12TH AVE., SUITE 100</b>	WEIGHT: <b>100</b>
MANUFACTURER: <b>SoloWorks 2016 SP2</b>			PART: <b>1221 W. 12TH AVE., SUITE 100</b>	WEIGHT: <b>100</b>	PART: <b>1221 W. 12TH AVE., SUITE 100</b>



3

6

D

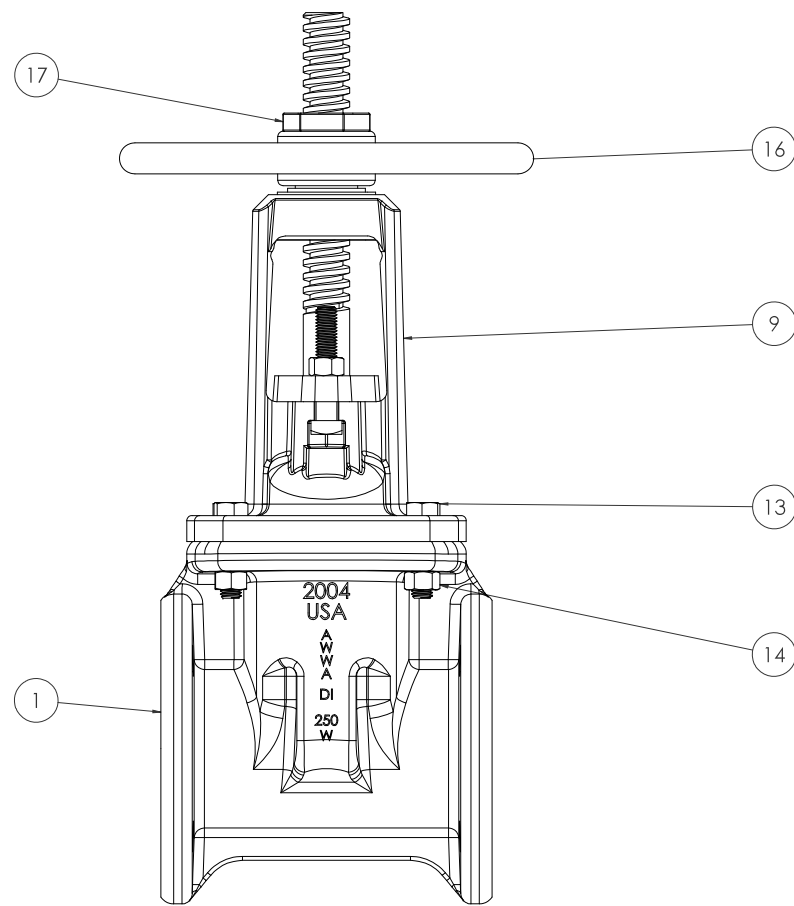
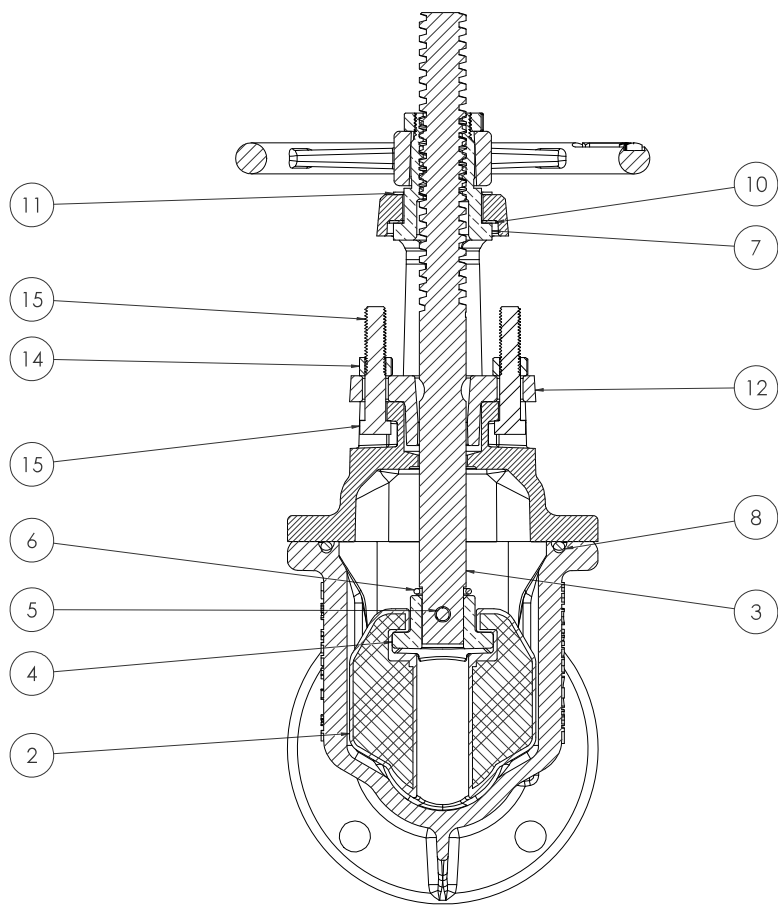

COMPANY: AWA ADDRESS: 1000 W. 10th St., Suite 100 DENVER, CO 80202 PHONE: (303) 733-1111 FAX: (303) 733-1112 WWW: www.awa.com		PRODUCT: 03" C509 OS&Y RESILIENT LBS. WEDGE GATE VALVE T:10 Soloworks 2016 SP2		
DATE: 12/1/2020 DRAWN BY: CW CHECKED BY:	REV: 1 DATE: 12/1/2020 BY: CW REASON:	PART NO: 03" C509 OS&Y RESILIENT LBS. WEDGE GATE VALVE T:10	MANUFACTURED IN: USA MATERIAL:	SHEET NO: 4 TOTAL SHEETS: 6 D

<u>ITEM NO.</u>	<u>COMPONENT</u>	<u>QTY.</u>	<u>SIZE</u>	<u>STANDARD MATERIAL</u>	<u>MATERIAL OPTIONS</u>
1	BODY	1	-	CAST IRON	DUCTILE IRON
2	WEDGE	1	-	EPDM/DUCTILE IRON	-
3	STEM	1	-	C65500	304 SS, 316 SS
4	STEM NUT	1	-	C87850	C87610 (LOW ZINC)
5	DRIVLOK PIN	1	5/16"X1 1/2	303 SS	316 SS
6	O-RING	1	#216	EPDM	BUNA-N
7	TOP STEM NUT	1	-	C86700	-
8	O-RING	1	#427	EPDM	BUNA-N
9	COVER	1	-	CAST IRON	DUCTILE IRON
10	THRUST WASHER	1	1 15/16"	NYLATRON	-
11	LOWER THRUST WASHER	1	2 3/32"	C26000	-
12	GLAND	1	-	CAST IRON	-
13	HEX HEAD CAP SCREW	4	1/2"-13 X 2"	18-8 SS	316 SS
14	HEX NUT	6	1/2"-13	18-8 SS	316 SS
15	SQUARE HEAD CAP SCREW	2	1/2"-13 X 2 3/4"	18-8 SS	316 SS
16	HANDWHEEL	1	10" DIA.	18-8 SS	316 SS
17	HOLD DOWN NUT	1	-	18-8 SS	316 SS

- VALVES CONFORM WITH THE FOLLOWING STANDARDS
  - AWWA C509
  - NSF 61
- LOW ZINC BRASS STEM AND STEM NUT AVAILABLE
- 100% DOMESTIC FASTENERS AND ORINGS OPTIONS AVAILABLE
- *OPEN LEFT* (COUNTERCLOCKWISE) AND *OPEN RIGHT* (CLOCKWISE) OPTIONS AVAILABLE
- TURNS TO OPEN FROM FULLY CLOSED: 9
- AWWA MAXIMUM ALLOWABLE CLOSING TORQUE 52 FT-LBS

<small>           COMPANY: <b>SOLOWORKS</b>            ADDRESS: 12000 W. 12TH AVE., SUITE 100, DENVER, CO 80202            PHONE: 303.751.1200            FAX: 303.751.1201            WWW: WWW.SOLOWORKS.COM         </small>		<small>           PROJECT: <b>03" C509 OS&amp;Y RESILIENT WEDGE GATE VALVE</b>            DATE: 12/1/2020            DRAWN BY: T.T.O.            CHECKED BY: S.S.P.         </small>		
<small>           CADD: T.T.O.            DATE: 12/1/2020            SCALE: 1"=1'-0"         </small>	<small>           MATERIALS: 18-8 SS            316 SS            EPDM            NYLATRON         </small>	<small>           WEIGHT: 150 LBS            DIMENSIONS: 10" DIA.         </small>	<small>           PART NO: T110            REV: 6         </small>	<small>           SHEET NO: 5            TOTAL SHEETS: 6         </small>